

Window Sill Installation

Window sills require a bit of cutting and fitting. **Install sill at a downward angle to provide for water run off from the house.**

- The space between the window frame and the horizontal furring strip has to be at least the thickness of your sill plus 1/8" (3mm) to insert the window sill.
- Cut the top of the bricks under the window if needed.
- Apply a large bead of adhesive along the top of the bricks and the horizontal furring.
- Insert sill blocks under window frame and set into adhesive.
- Insert a small filler piece and attach with adhesive.
- Caulk between bottom of window and top of sill.

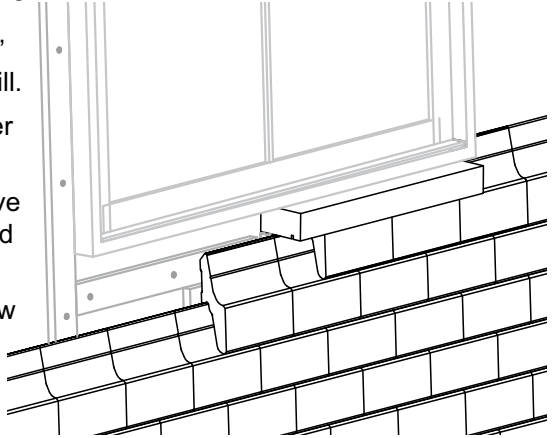

Cut filler pieces to fit under the window sill and secure with adhesive.

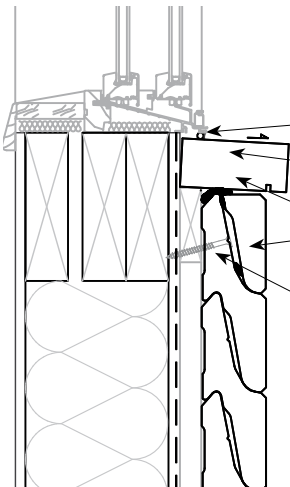
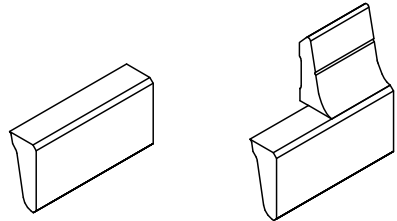

caulk between window frame and sill

#8 or # 10 x 4" (100mm) corrosion-res screw, either on the sides or underneath the sill.

secure sill and filler piece with construction adhesive.

fasten each Novabrik under window sill with 2 screws, cut the top of the bricks if necessary

Note: If necessary cut sills to equal length for a better harmonized look under the window.